

ROYAL Vision VENDER™



The Future
In Glass Front
Venders

Featuring:

- **Precision Delivery System** for upright product delivery
- 20 individual cells for easy loading and modularity
- Mechanical simplification for enhanced reliability
- Standard footprint (35.5" x 37")
- **First In, First Out** dispensing



THE FUTURE IN GLASS FRONT VENDERS

A Revolutionary Glass Front Design

Maximize your profits with the Vision Vender

- Precision Delivery System for upright product delivery
 - Delivers product without free fall, thus eliminating product foaming
- Mechanical Simplification for Enhanced Reliability
 - No Wiring or Motors on the Precision Delivery System
 - No Solenoids, Wiring or Switches In/On Product Shelves
- 20 Individual Cells for Easy Loading
- Accommodate 40 SKU's
- First In, First Out (FIFO) dispensing
- Standard footprint (35.5" x 37") for easy vender placement
 - Able to be "Stacked" In Inventory
- Electronic Refrigeration
- Delivery Optic Sensor For Vend Validation
- Equipped with energy efficient T8 Lighting

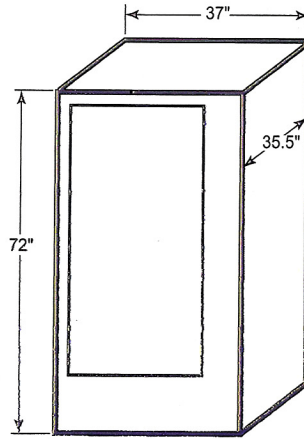

RVV 400

Standard Cabinet:

Shelves:	5	
Selections:	40	
Cells:	20	
Weight:	760 lbs (345 kg)	
Width:	37" (94 cm)	
Depth:	35.5" (90 cm)	
Height:	72" (182 cm)	
CAPACITIES:	total	Per Cell
12 oz. Can:	320	16
20 oz Bottle:	280	14

*Capacities may vary, due to package variation

QUALITY • INNOVATION • SERVICE

Pepsi, Pepsi-Cola and the Pepsi Globe are registered trademarks of PepsiCo, Inc.



ROYAL VENDORS, INC
Bardane Industrial Park
426 Industrial Boulevard
Kearneysville, WV 25430



P: 304.728.7056
P: 800.321.8637
F: 304.725.4016
www.royalvenders.com